

8 7 6 5 4 3 2 1

40 GALLON GEMINI	PART NUMBER	
	BLUE	NATURAL
STANDARD (1.5 SPG)	01-29436	01-29437
HD (1.9 SPG)	01-29775	01-29766

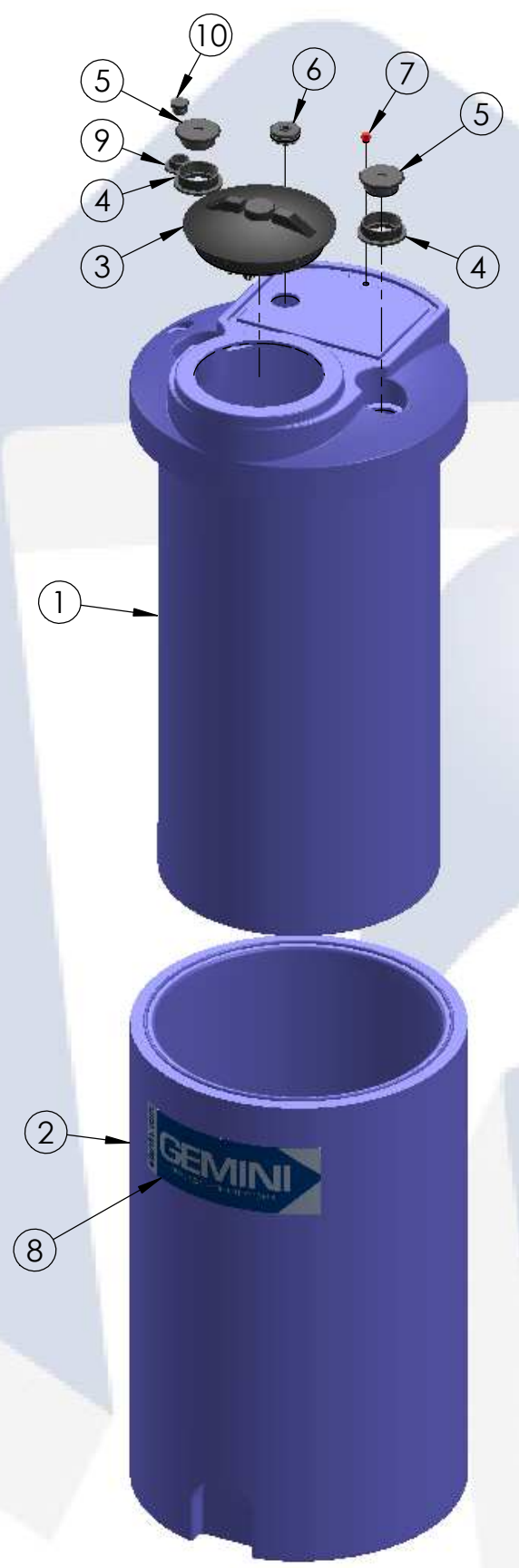

**ISO VIEW  
(ASSEMBLED)**



**TRIMETRIC VIEW  
(EXPLODED)**

ITEM NO.	DESCRIPTION	QTY.
1	40G GEMINI PRIMARY TANK	1
2	40G GEMINI SECONDARY TANK	1
3	8" TWIST LID ASSEMBLY	1
4	2" FNPT SPIN WELD FITTING, PE	2
5	2" THREADED PLUG, PE	2
6	2" CAPLUG / GROMMET SUB-ASSY	1
7	RED CAPLUG / O-RING SUB-ASSY	1
8	MOLD IN GRAPHIC	1
9	3/4" FNPT SPIN WELD FITTING, PE	1
10	3/4" THREADED PLUG, PE	1

- NOTES:**
- CAPACITY: 40 GAL. NOMINAL
  - APPROXIMATE WEIGHT: 43 LBS
  - TANK MATERIAL: LLDPE W/ UV INHIBITOR
  - SERVICE PRESSURE: ATMOSPHERIC

**PROPRIETARY AND CONFIDENTIAL**  
 THE INFORMATION CONTAINED IN THIS DRAWING IS THE SOLE PROPERTY OF PEABODY ENGINEERING. ANY REPRODUCTION IN PART OR AS A WHOLE WITHOUT THE WRITTEN PERMISSION OF PEABODY ENGINEERING IS PROHIBITED.

UNLESS OTHERWISE SPECIFIED:		NAME	DATE
DIMENSIONS ARE IN INCHES		DRAWN	MSM 11/25/13
TOLERANCES: ±1/4"		CHECKED	
ANGULAR: ±.5°		ENG APPR.	
ONE PLACE DECIMAL: ±.25		MFG APPR.	
TWO PLACE DECIMAL: ±.125		Q.A.	
THREE PLACE DECIMAL: ±.063		<b>ALTERNATIVE VERSIONS</b>	
TANK MATERIAL:	LLDPE	MATERIALS: XLPE, PPL, PVDF	
INNER TANK S/N:		COLORS: NATURAL, BLUE OR BLACK	
OUTER TANK S/N:		AVAILABLE WITH FRP WRAP	
CUSTOMER PO#		<b>CALL FOR PART NUMBERS</b>	
DO NOT SCALE DRAWING			

PROJECT: <b>40 GALLON GEMINI TANK ASSEMBLY</b>		
CUSTOMER: <b>PEABODY STANDARD</b>		
SITE/LOCATION: -		
DRAWING#: <b>SEE TABLE</b>		
SIZE	DESC.	REV.
<b>B</b>	<b>PEABODY 40 GALLON GEMINI</b>	<b>A</b>
SCALE: 1:10		SHEET 1 OF 2

D  
C  
B  
A

D  
C  
B  
A

8 7 6 5 4 3 2 1

8 7 6 5 4 3 2 1

D  
C  
B  
A

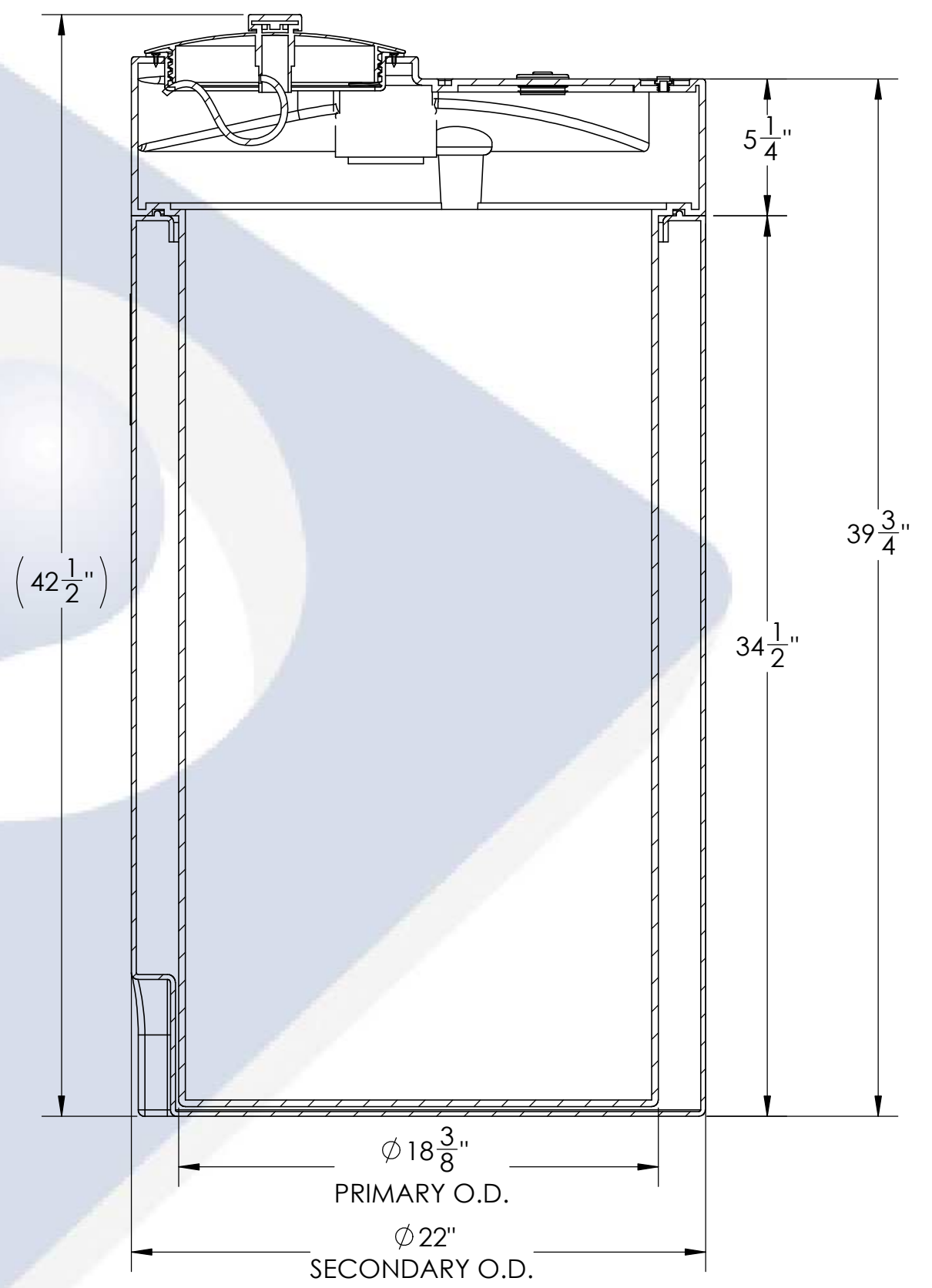
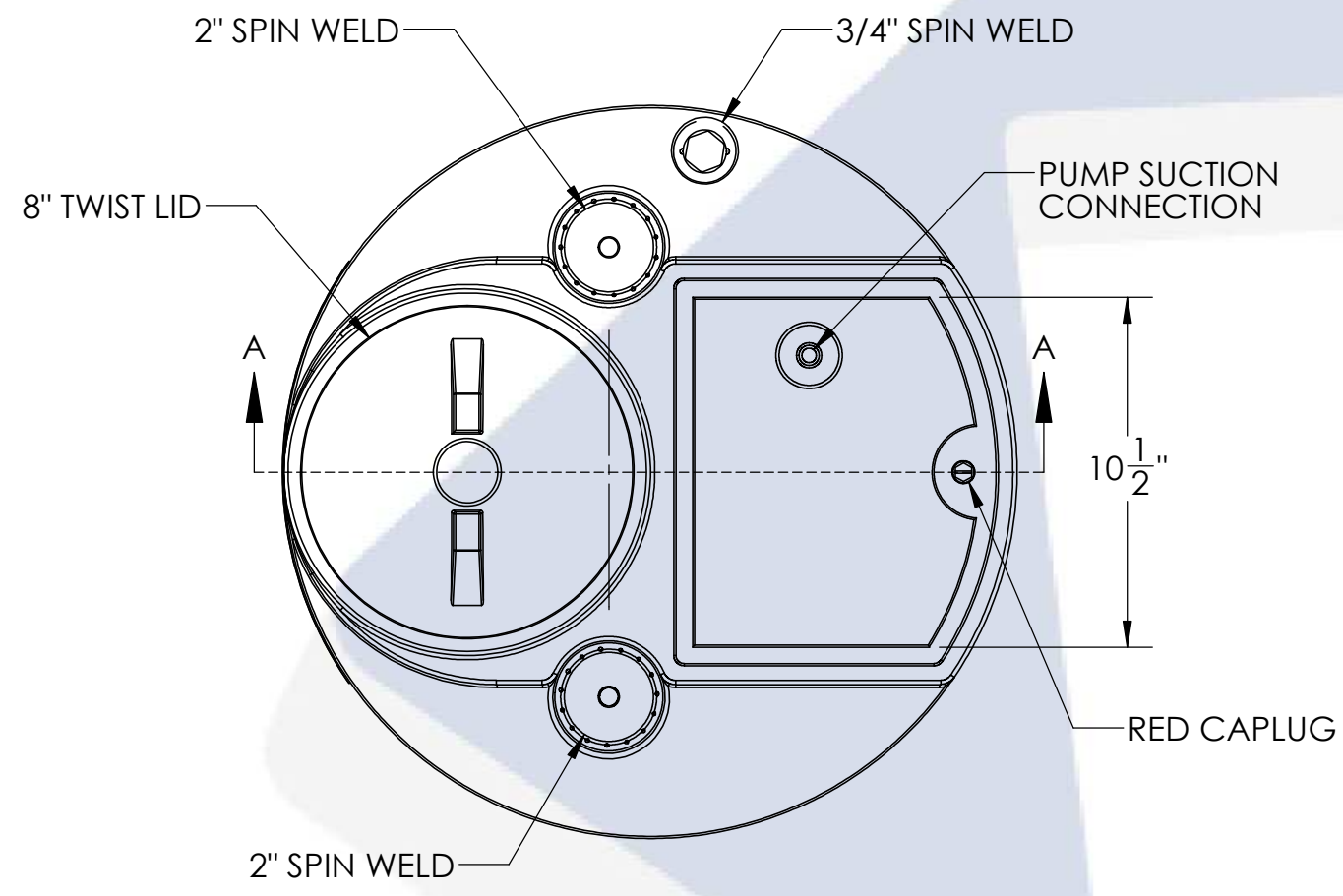

SECTION A-A  
SCALE 1 : 6



PROJECT:  
40G GEMINI TANK ASSEMBLY FOR CUSTOMER,  
REV.A

SCALE: 1:6

SHEET 2 OF 2

8 7 6 5 4 3 2 1